

PV-公电缆连接器
PV-KST4...-UR
PV-母电缆连接器
PV-KBT4...-UR

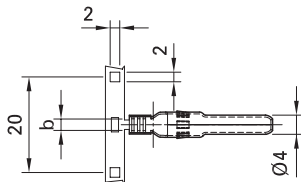
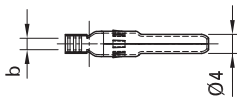
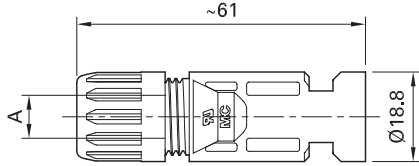

PV-Male cable coupler
PV-KST4...-UR
PV-Female cable coupler
PV-KBT4...-UR

PV-KST4...-UR

PV-KBT4...-UR

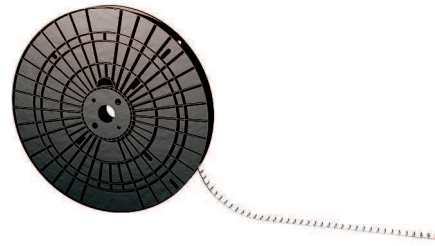

Raccord mâle PV
PV-KST4...-UR
Raccord femelle PV
PV-KBT4...-UR

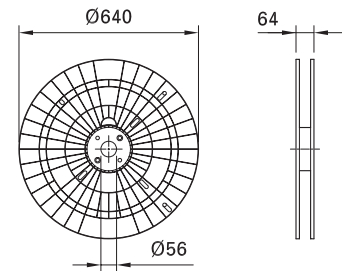
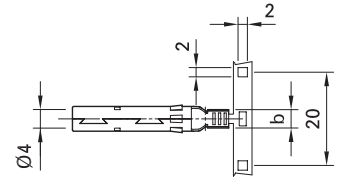
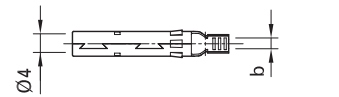
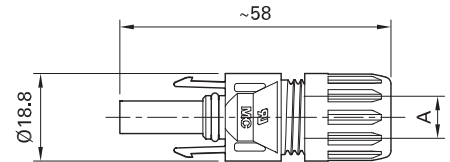

一卷有**2000**个金属插头¹⁾
 (用于半自动安装)

2000 contacts mounted on reels¹⁾
 (for semi-automatic processing)

2000 contacts livrées en bandes¹⁾
 (pour des confections semi-automatisées)

UL-Recognized
 File No. E 181720

技术参数

Technical data

额定电流 Rated current Intensité assignée	17A (1,5mm ²) 22A (2,5mm ² ; 14AWG) 30A (4mm ² , 6mm ² ; 12AWG)
额定电压 Rated voltage Tension assignée	1000V (IEC/CEI) 600V (UL)
测试电压 Test voltage Tension de test	6kV (50Hz, 1min.)
过压等级/污染等级 Overvoltage category/Pollution degree Catégorie de surtension/Degré de pollution	CATIII/2
插头连接器的接触电阻 Contact resistance of plug connectors Résistance de contact des connecteurs	0,5mΩ
金属插头材料 Contact material Matériau conducteur	铜, 镀锡 copper, tin plated cuivre, étamé
绝缘材料 Insulation material Matériau isolant	PC / PA
金属插头系统技术 Contact system Système de contact	MC Multilam MC Multilam Contact à lamelles MC

Caractéristiques techniques

锁紧系统 Locking system Système de verrouillage	Snap-in
防护等级, 插合状态 Degree of protection, mated Degré de protection, connecté	IP67
触摸保护, 未插合状态 Degree of protection, unmated Degré de protection, déconnecté	IP2X
安全等级 Safety class Classe de protection	II
火焰等级 Flame class Classe d'inflammabilité	UL94-V0
消除电缆应力依据 Cable strain relief according to Rétention du câble selon	DIN V VDE 0126-3
环境温度范围 Ambient temperature range Plage de température ambiante max.	-40°C...+90°C (IEC/CEI) -40°C...+75°C (UL)
温度上限 Upper limiting temperature Limite de température supérieure	105°C (IEC/CEI)

¹⁾ 卷盘类型可有改变

¹⁾ Reel type subject to alterations

¹⁾ Type du rouleau sous réserve

PV-KST4...-UR



公电缆连接器作为单独的零件提供
(包括绝缘部件)

Male cable coupler as individual parts
(including insulating parts)

Raccords mâles en pièces détachées
(isolants inclus)

型号 Type Type	订货号 Order No. No. de Cde	Ø电缆固定头的直径范围 Ø range of cable gland Ø sur isolant du câble	导线截面积 Conductor cross section Section du câble		压接工具 Crimping tool Outil de sertissage	认证 Approvals Approbations
			mm ²	AWG		
		A (mm)			b (mm)	
PV-KST4/2,5I-UR	32.0011P0001-UR	3 – 6	1,5 – 2,5	14	3	PV-CZM ¹⁾
PV-KST4/2,5II-UR	32.0013P0001-UR	6 – 9	1,5 – 2,5	14	3	PV-CZM ¹⁾
PV-KST4/6I-UR	32.0015P0001-UR	3 – 6	4 – 6	12 / 10	5	PV-CZM ¹⁾
PV-KST4/6II-UR	32.0017P0001-UR	6 – 9	4 – 6	12 / 10	5	PV-CZM ¹⁾



公电缆连接器装在支撑带上
(2000个零件装在卷盘上, 包括绝缘
部件在内)

Male cable coupler on carrier band
(on reels of 2000 pieces including
insulating parts)

Raccords mâles montés sur bande
(à 2000 pièces, isolants inclus)

PV-KST4/2,5I-UR	32.0011P2000-UR	3 – 6	1,5 – 2,5	14	3	2)
PV-KST4/2,5II-UR	32.0013P2000-UR	6 – 9	1,5 – 2,5	14	3	2)
PV-KST4/6I-UR	32.0015P2000-UR	3 – 6	4 – 6	12 / 10	5	2)
PV-KST4/6II-UR	32.0017P2000-UR	6 – 9	4 – 6	12 / 10	5	2)



PV-KBT4...-UR



母电缆连接器作为单独零件提供
(包括绝缘部件)

Female cable coupler as individual parts
(including insulating parts)

Raccords femelles en pièces détachées
(isolants inclus)

型号 Type Type	订货号 Order No. No. de Cde	Ø电缆固定头的直径范围 Ø range of cable gland Ø sur isolant du câble	导线截面积 Conductor cross section Section du câble		压接工具 Crimping tool Outil de sertissage	认证 Approvals Approbations
			mm ²	AWG		
		A (mm)			b (mm)	
PV-KBT4/2,5I-UR	32.0010P0001-UR	3 – 6	1,5 – 2,5	14	3	PV-CZM ¹⁾
PV-KBT4/2,5II-UR	32.0012P0001-UR	6 – 9	1,5 – 2,5	14	3	PV-CZM ¹⁾
PV-KBT4/6I-UR	32.0014P0001-UR	3 – 6	4 – 6	12 / 10	5	PV-CZM ¹⁾
PV-KBT4/6II-UR	32.0016P0001-UR	6 – 9	4 – 6	12 / 10	5	PV-CZM ¹⁾



母电缆连接器装在支撑带上
(2000个零件装在卷盘上, 包括绝缘
部件在内)

Female cable coupler on carrier band
(on reels of 2000 pieces including
insulating parts)

Raccords femelles montés sur bande
(à 2000 pièces, isolants inclus)

PV-KBT4/2,5I-UR	32.0010P2000-UR	3 – 6	1,5 – 2,5	14	3	2)
PV-KBT4/2,5II-UR	32.0012P2000-UR	6 – 9	1,5 – 2,5	14	3	2)
PV-KBT4/6I-UR	32.0014P2000-UR	3 – 6	4 – 6	12 / 10	5	2)
PV-KBT4/6II-UR	32.0016P2000-UR	6 – 9	4 – 6	12 / 10	5	2)



¹⁾ 见42页

²⁾ 应客户要求可提供半自动化压接设备
或安装设备的相关信息

¹⁾ See page 42

²⁾ Information about a semi-automatic crimp device
or assembly device, on request

¹⁾ Voir page 42

²⁾ Informations concernant les outils de sertissage
ou de montage, sur demande



密封盖, 见41页



Sealing caps, page 41



Bouchons de protection, p. 41



安装工具, 见41页



Assembly tools, page 41



Outils de montage, page 41



安全锁紧夹, 见44页



Safety lock clip, page 44



Clip de sécurité, page 44



安装说明 MA231

www.multi-contact.com



Assembly instructions MA231

www.multi-contact.com



Instructions de montage MA231

www.multi-contact.com